

Version 1.1

Setup group device Samsung smartphone/tablet (Android 14)

DB System

Digital bewegen. Gemeinsam.

Table of contents

1 First Steps	3
1.1 Start setup	3
1.2 Scan QR Code	5
1.3 WI-FI	6
2 Register smartphone/tablet in the DB	8
2.1 Establish connection	8
2.2 Log in with the group account	9
2.3 Set up work profile	10
2.4 Set up hub	11
2.5 Setup screen lock	12
2.6 Setup Google Services	13
2.7 Agree to Samsung terms and conditions	14
3 Necessary settings	16
3.1 Set up Launcher	16
4 Admin Mode	19
4.1 Exit Launcher	19
4.2 Configure power button	21
4.3 Launch Launcher again	22

1 First Steps

The device must be integrated into DB Systel's Enterprise Mobility Management. Some adjustments are necessary for this. In the following, all relevant clicks are highlighted by a **red frame**.

Before resetting to factory settings, back up your work and private data and settings. You can find instructions on how to back up your data here: > www.db.de/ae.

1.1 Start setup

After unpacking or resetting the device, follow the on-screen instructions to set up the device.

During setup, make sure your smartphone/tablet is connected to the internet, otherwise you will not be able to complete the setup.

- Make sure that the smartphone/tablet is either connected to the power supply or has a high battery level during the setup.
- Turn on the device.

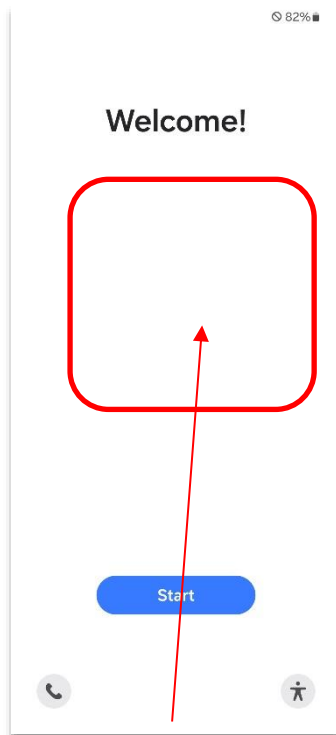

- Tap **ten times** in the free area on the screen, **do not tap Start**.

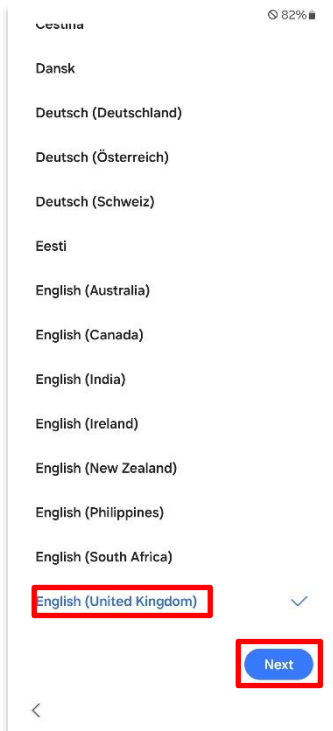

- Check whether the desired language is selected. If not, adjust it.



- The camera opens.

1.2 Scan QR Code

- Scan the following QR code:
- Using WI-FI:



- Using mobile data:



If the QR code does not work, you can also find all QR codes here:
> mobileworkplace.deutschebahn.com/QR-Code-PRD

1.3 WI-FI

Next, set up the Wi-Fi.

- If you are in a DB building:

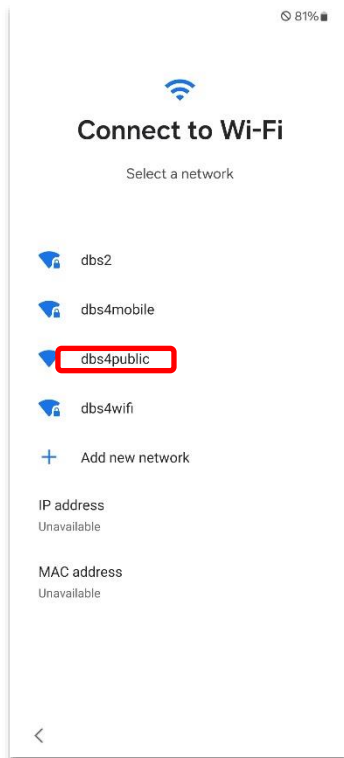

- Tap on the WLAN „dbs4public“.

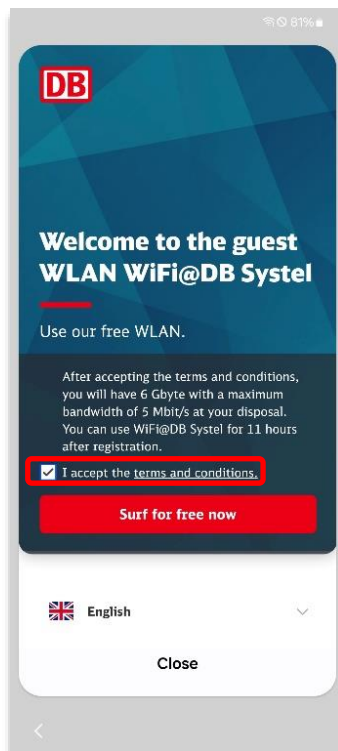

- A dialogue opens, accept the terms and conditions.
- Tap on "Surf for free now".

- Tap on „Close“.



Note: If the connection with the WLAN "dbs4public" fails:

- Tap the "Start" button on the system start screen (see chapter 1.1).
- Then select the WLAN.

If **no DB WLAN** is available (e.g. because you are at home):

- Tap your personal Wi-Fi.
- Enter your personal login data and tap on "Connect".
- Tap on "Next".

2 Register smartphone/tablet in the DB

In the next step, your DB smartphone/tablet must be linked to the DB network (more precisely in Enterprise Mobility Management, or EMM for short). Follow the instructions on the screen.

2.1 Establish connection

The smartphone/tablet is set up.

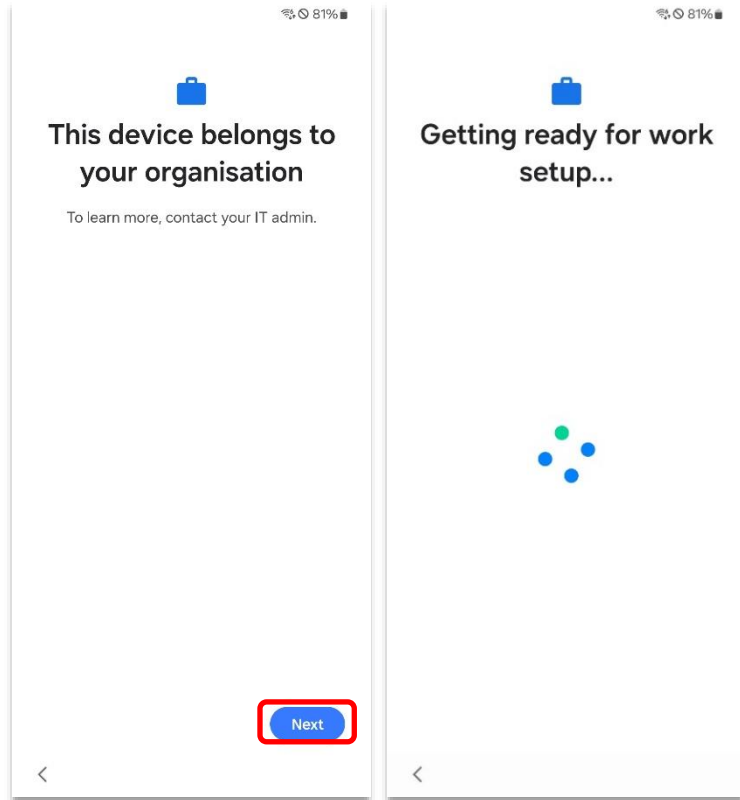

- Confirm the following queries with "Next" and, if applicable, "Accept and Continue".

2.2 Log in with the group account

Enter the login details for the group account.

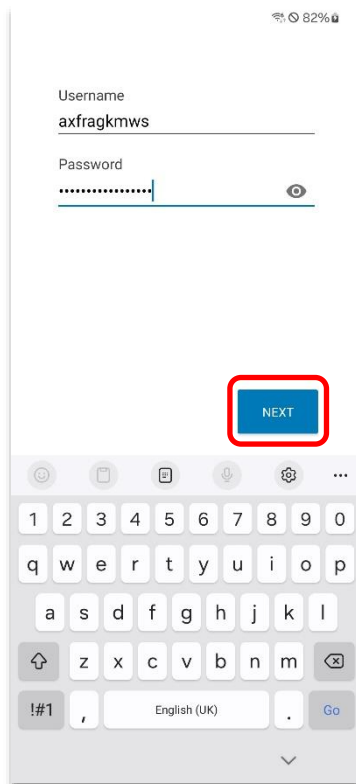

- Tap **Next**, the configuration of the device begins.

2.3 Set up work profile

- The applications (apps) will now be installed automatically. This process can take a few minutes. The work profile is then set up.

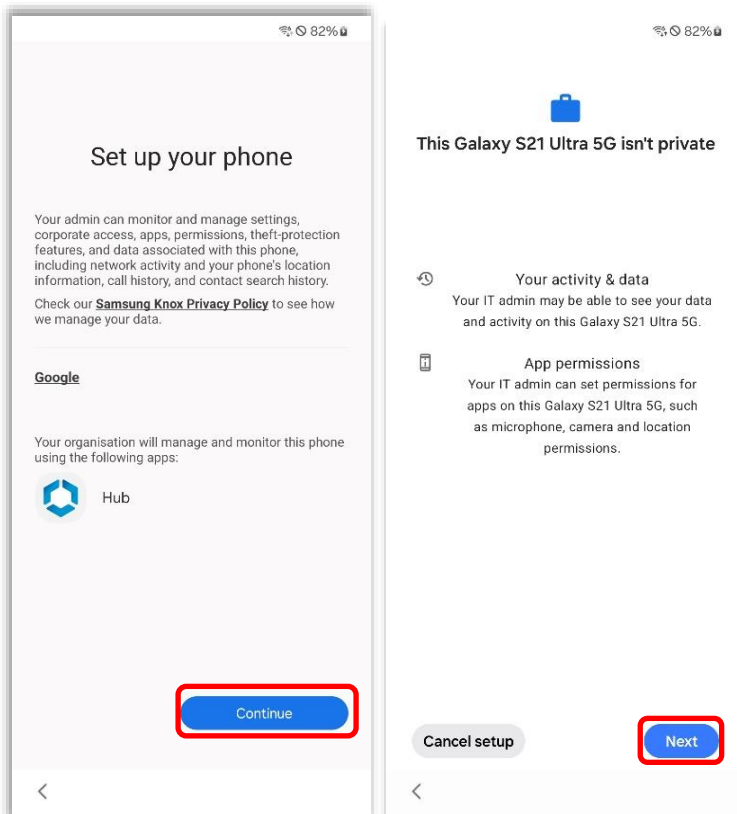

- Tap "Next" several times.

2.4 Set up hub

On the next page, set up the permissions for the hub.

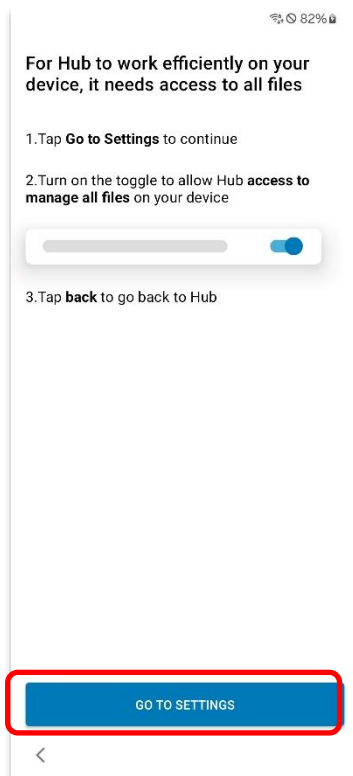

- Tap on "Go to settings".

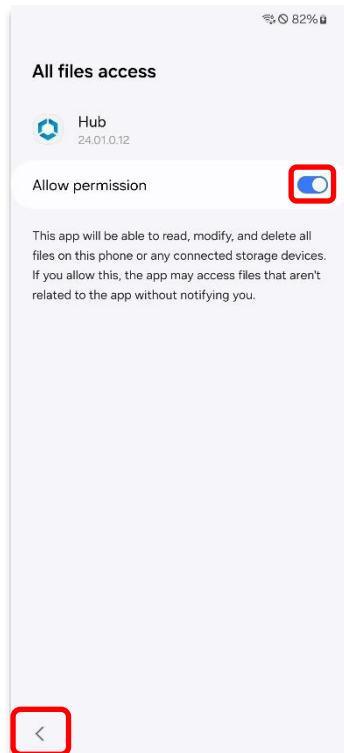

- Slide the slider to the right to give Hub permission.
- Then tap the arrow at the bottom left to go back.

2.5 Setup screen lock

Set up a screen lock (password to lock the display).

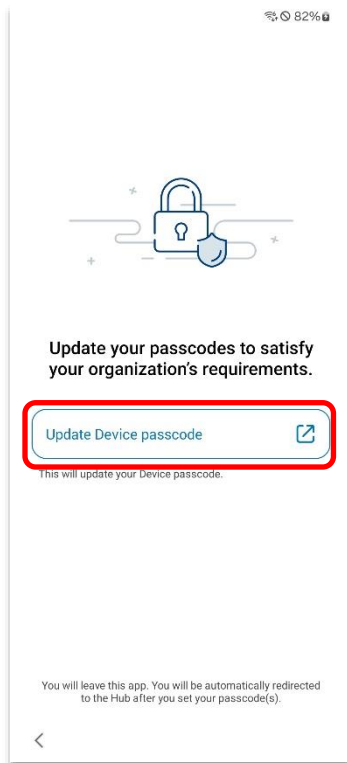

- Tap on "Update device passcode" and then on "Password".

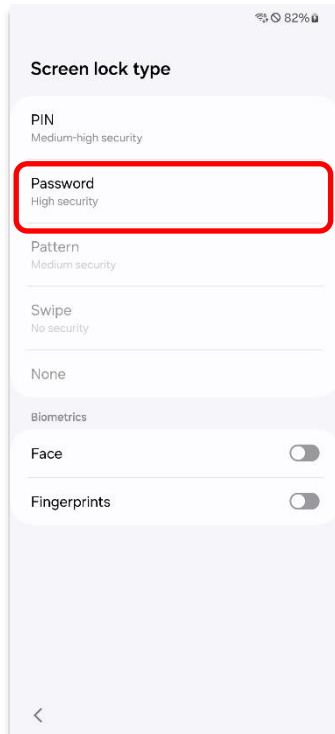

- Set a password. The password must consist of at least 6 characters including one letter.
- Enter the password again.
- Tap on „OK“.

2.6 Setup Google Services

To use the Google Play Store for business apps, it is necessary to accept the Google Terms of Use. Proceed as follows:

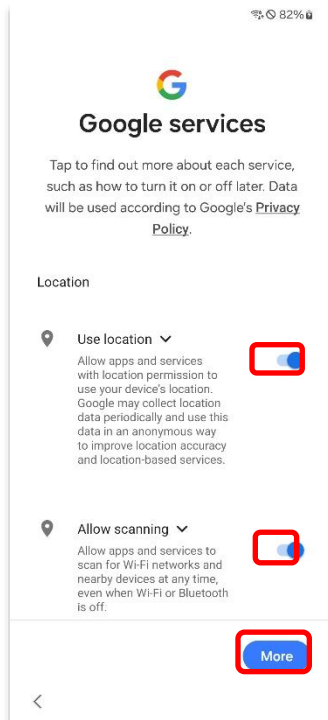

- Tap on "More" to see the other settings.
- **Send usage data & error reports:** Slide the slider to the left, the function is switched off.

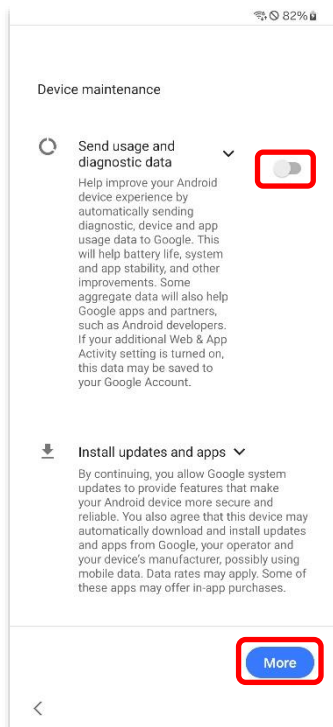

- Scroll all the way down and tap "Accept".

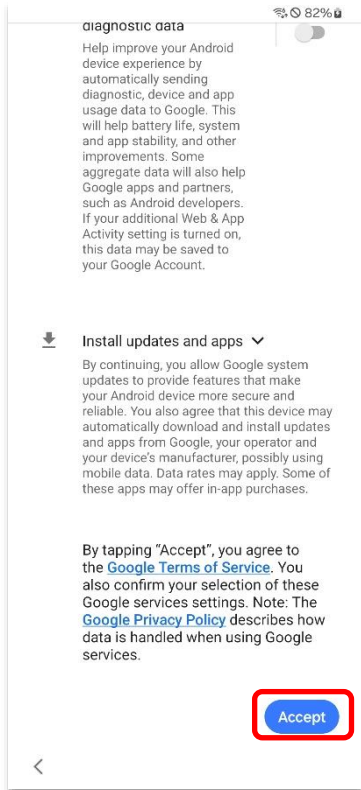

2.7 Agree to Samsung terms and conditions

In the next step, accept the terms and conditions of Samsung.

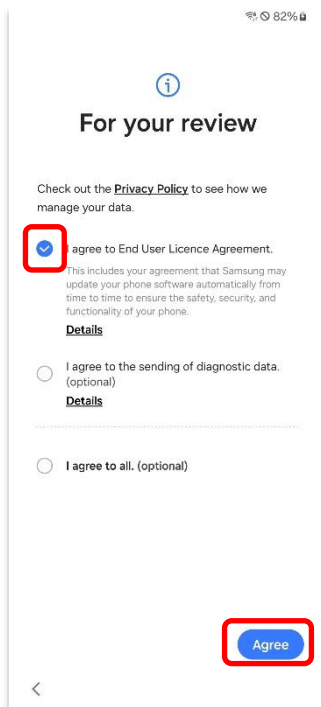

- Tap on „Agree“.

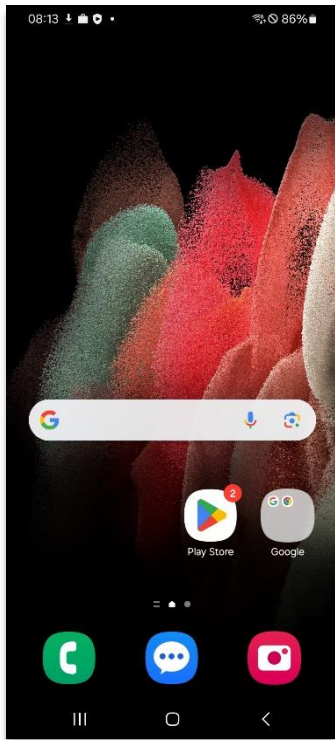

When this screen appears, the device is set up and the Launcher app will be installed soon.

3 Necessary settings

3.1 Set up Launcher

The Launcher app starts automatically. Set up the permissions for the Hub and Launcher app.

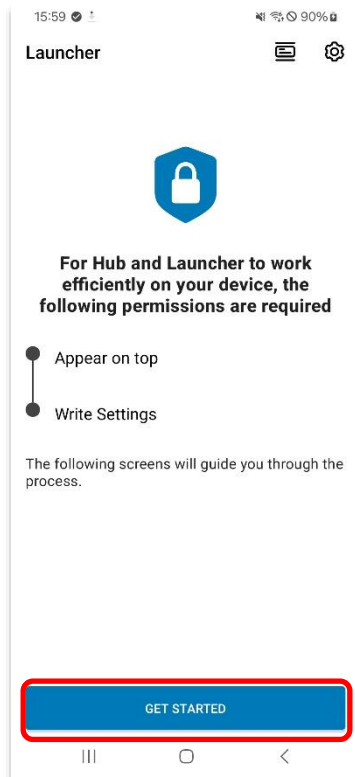

■ Tap on „Get Started“.

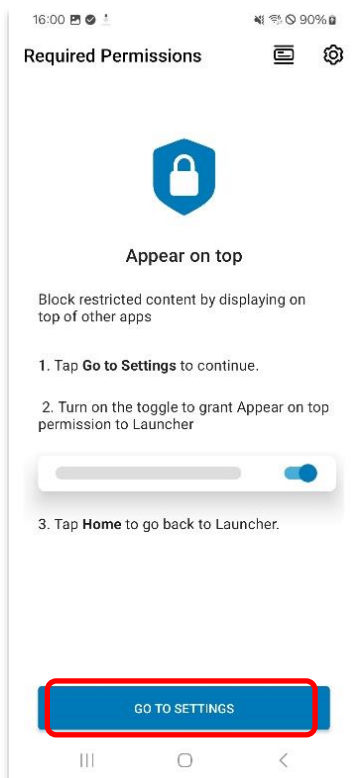

■ Tap on „Go to settings“.

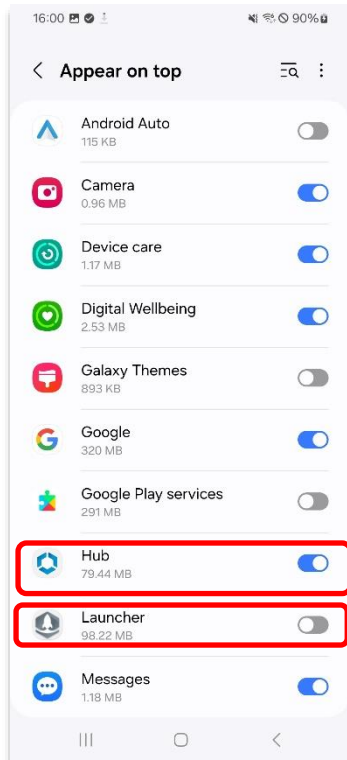

- **Hub:** Move the slider to the right to give the hub app permissions.
- **Launcher:** Move the slider to the right to switch the function on.

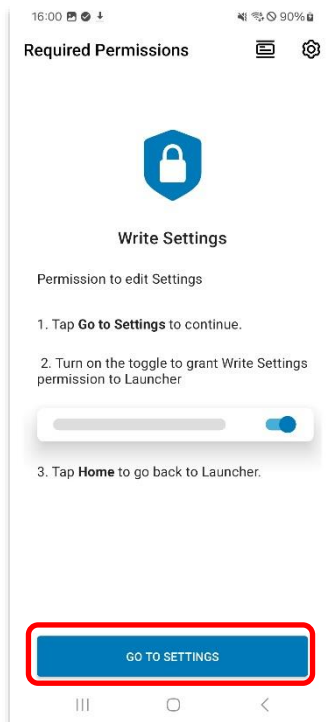

- Tap on „Go to settings“.

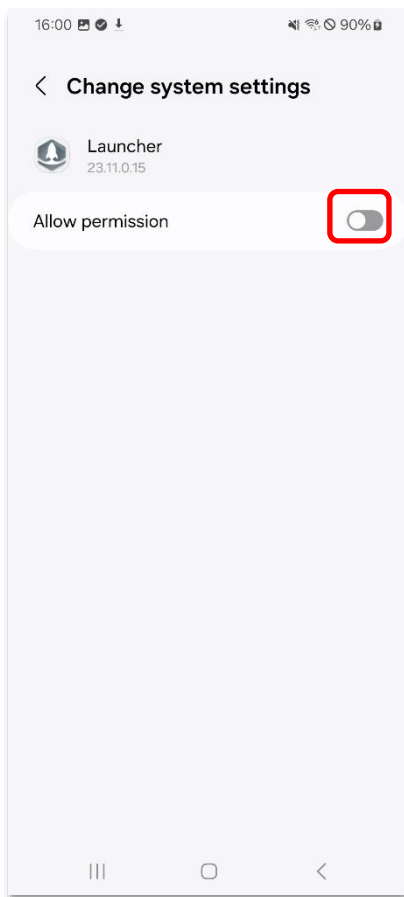

- Move the slider to the right to give Launcher permission.
- As soon as the workspace is loaded, this view appears:

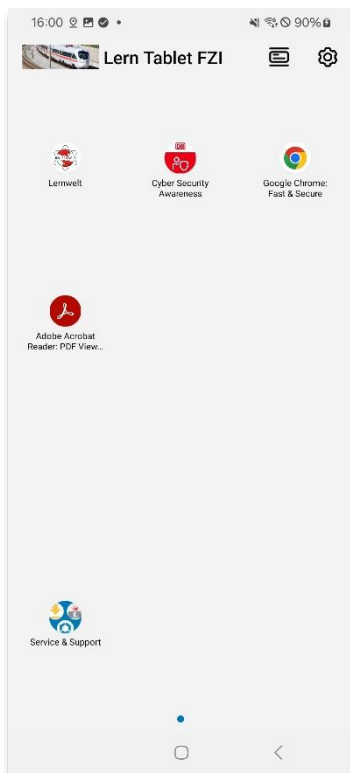

4 Admin Mode

4.1 Exit Launcher

The user who has the admin passcode can make changes to the device.

To do this, the admin mode must be activated and the launcher must be closed:

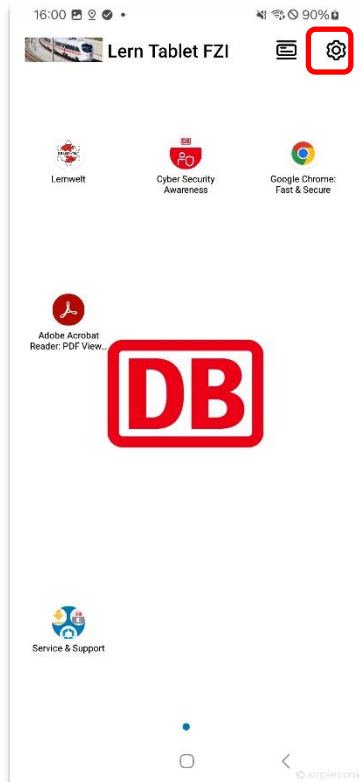

- On the start page, tap the cogwheel icon in the top right-hand corner.
- The settings open.

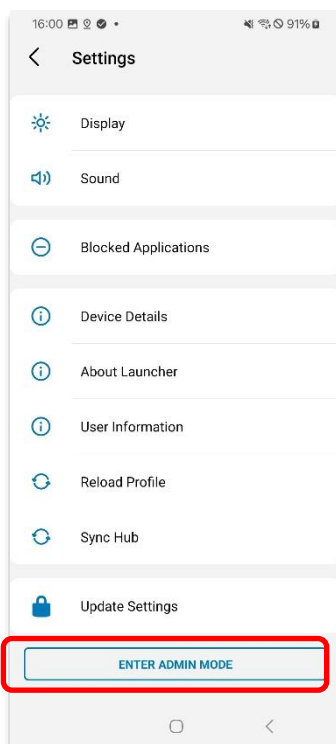

- Tap on "Enter Admin Mode".

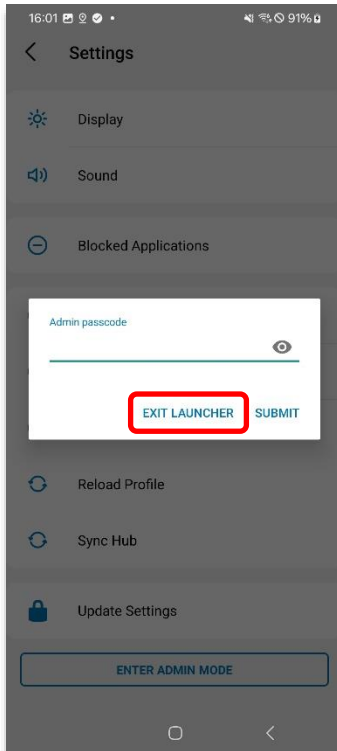

- Enter the administrator passcode in the field.
- Then tap on "Exit Launcher".

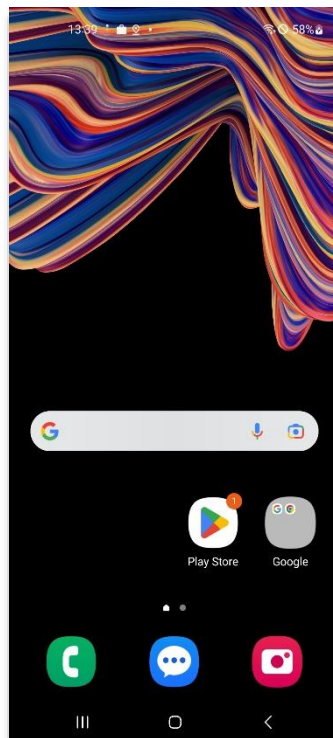
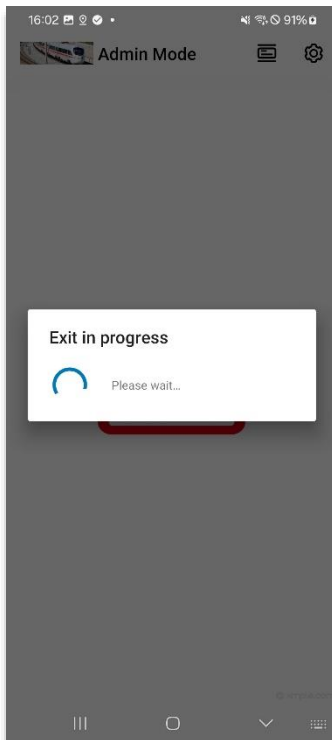

4.2 Configure power button

The power button is configured for the Bixby service by default. To enable the smartphone/tablet to be switched off or restarted as usual with the power button, adjust the setting for the power button:

- Swipe the screen once from top to bottom.

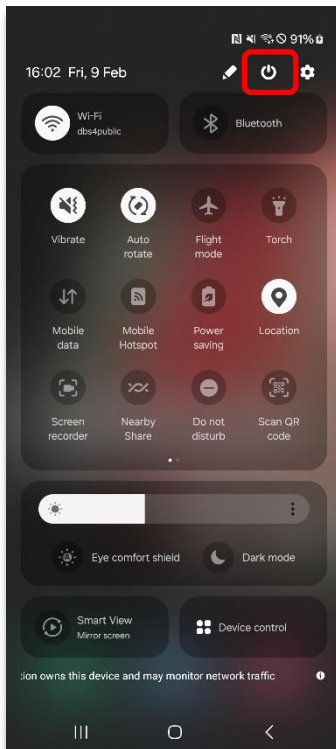

- Tap the power button.
- The settings will open.

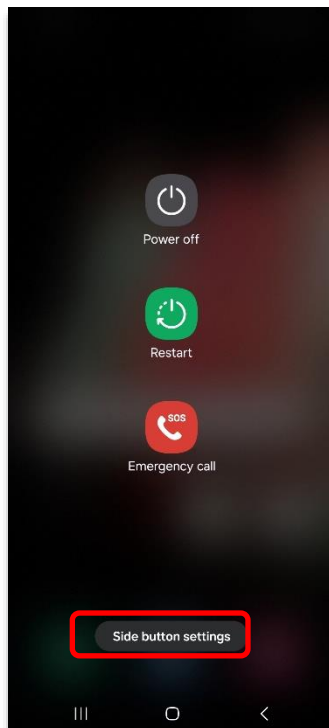

- Tap on „Side button settings“.

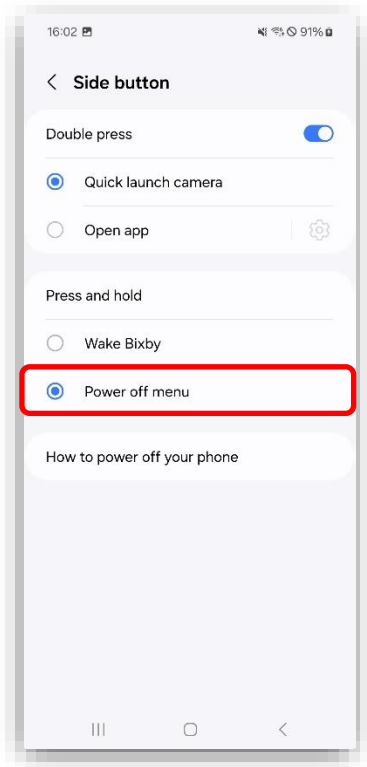

- Choose option „Power off menu“.
- Then exit the menu.

4.3 Launch Launcher again

To start the launcher again, tap the "Home button" of the device.

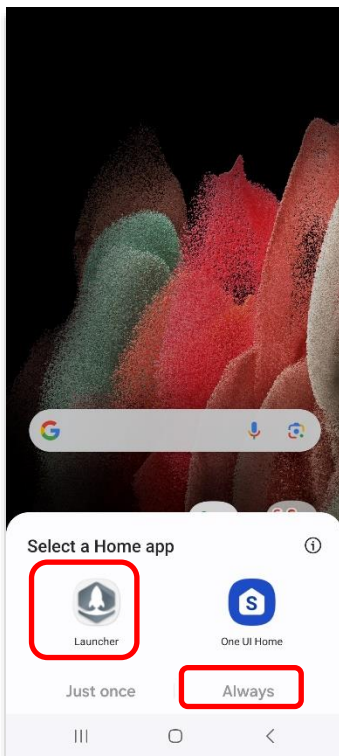

- Tap "Always" in the menu.
- The Launcher app starts.