

Restore Nokia Smartphone/Tablet (Android One Operating System)

DB System

Digital bewegen. Gemeinsam.

Table of contents

1 First steps	3
1.1 Factory reset	3
1.2 Start recovery	4
1.3 Scan QR Code	5
QR Code standard devices	6
QR Code RiM devices	8
QR Code Group Account devices	10
QR Code Multi User Service	12
1.4 Set up WLAN	14
2 Register in the DB company network	16
2.1 Connect	16
2.2 Log in with the DB User	17
2.3 Work profile	18
2.4 Only for Android version 12: Create screen lock (password)	21
2.5 Skip Google Services	23
2.6 Only for Android version 11: Create screen lock (password)	25
2.7 Finalise setup	27
2.8 Check certificates	30
3 Necessary settings	32
3.1 Search for operating system updates	32
3.2 Activate Welcome App	34
3.3 Activate MTD App	35

1 First steps

If there are problems with your smartphone/tablet or if you want to reset it, a factory reset is helpful.

1. Before resetting to factory settings, back up your work and private data and settings. You can find instructions for backing up your data here:

> mobileworkplace.deutschebahn.com/mobile-daten-sichern

2. Reset your device.

You have already worked with your smartphone/tablet: go to **step a) in chapter 1.1.**

You have neither worked with your smartphone/tablet nor activated the *Welcome App*: go to **step c) in chapter 1.1.**

Note: If you have problems with your **PC**, you can find help on > [IT ServiceDesk App.](#)

1.1 Factory reset

After you have backed up your data, perform the *factory reset*. There are different variants, choose the one that suits you best:

a) **Reset Smartphone/Tablet in the Digitalshop:**

- Open the page > db.de/digitalshop
- Tap on "Inventory data".
- Select "Mobile devices" and choose your smartphone/tablet.
- Tap on the field "Execute inventory action" and select the action "Mobile device - EMM device reinstallation" and tap on "Open".
- A summary opens. Tap "Add to cart" on the right.
- Then go to the shopping cart, accept the GTC and tap on "Order".
- Wait approx. 30 minutes. Your device will be reset automatically.

b) **Reset Smartphone/Tablet with the IT ServiceDesk:**

- Contact the **IT ServiceDesk** with the IT ServiceDesk App or on +49 361 430-8200 and ask them to reset the device to factory settings.

c) **Reset Smartphone/Tablet yourself:**

- Go to the "*Personal*"/"Private" section on your smartphone/tablet and tap on the "*Settings*" app.
- Tap on "System".
- Scroll down further and tap "*Reset*".
- Select "Reset to factory settings".
- You will see a message telling you what will be deleted by the reset. When you have backed up all your service data, tap the "*Reset*" button.
- Wait a few minutes, your device will be reset automatically.

1.2 Start recovery

To be able to use all DB apps on your smartphone/tablet again after a factory reset, follow the on-screen instructions to set up the device.

During setup, make sure your smartphone/tablet is connected to the internet, otherwise you will not be able to complete the setup.

- Make sure that your smartphone/tablet is either connected to the power supply or has a high battery level during the recovery process.
- Switch on the smartphone/tablet.

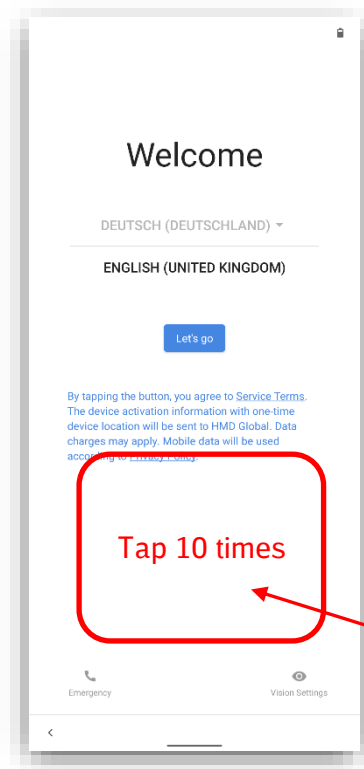

- Check whether the desired language is selected. If not, adjust it.
- In the installation help, **don't tap Lets Go**, but tap the free area on the screen **ten times**.



- The camera opens.

1.3 Scan QR Code

Scan the QR code that suits you. Below you will find the QR codes for:

- Standard devices
- RIM devices
- Group devices
- Multi user devices

QR Code standard devices

- If Wi-Fi is available:



- If no Wifi and only mobile data is available:



Here you will find the QR codes for special devices:

QR Code RiM devices

- If Wi-Fi is available:



- If no Wifi and only mobile data is available:



QR Code Group Account devices

- If Wi-Fi is available:



- If no Wifi and only mobile data is available:



QR Code Multi User Service

■ If Wi-Fi is available:



- If no Wifi and only mobile data is available:



If the QR code does not work, you can also find all QR codes here:
> mobileworkplace.deutschebahn.com/QR-Code-PRD

1.4 Set up WLAN

Next, set up the Wi-Fi.

- If you are in a **DB building**:

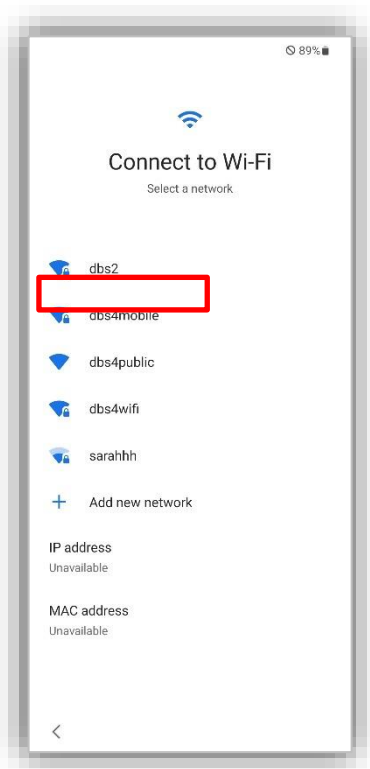

- Tap on the WLAN "*dbs4public*".

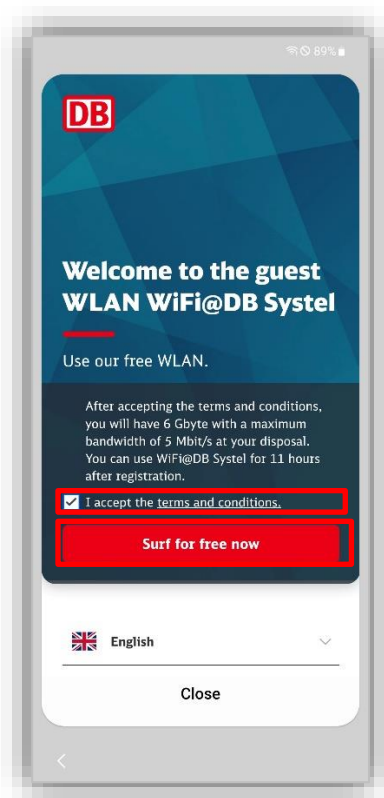

- A dialogue opens, accept the terms and conditions.
- Tap on "Surf for free now".

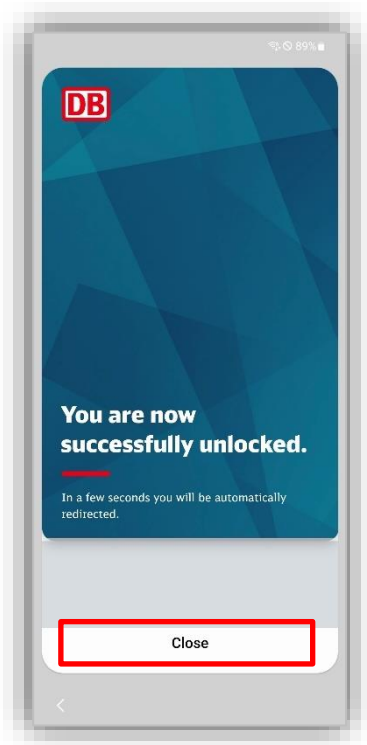

- Tap on "*Close*".

Note: If the connection to the "dbs4public" WLAN fails:

- Tap the "*Start*" button on the system start screen (see **chapter 1.2**).
- Then select the WLAN.

If **no DB WLAN** is available (e.g. because you are at home):

- Tap your personal Wi-Fi.
- Enter your personal login data and tap on "*Connect*".
- Tap on "*Next*".

2 Register in the DB company network

In the next step, your DB smartphone/tablet must be linked to the DB network again (more precisely in Enterprise Mobility Management, or EMM for short). Follow the instructions on the screen.

2.1 Connect

The smartphone/tablet is set up.

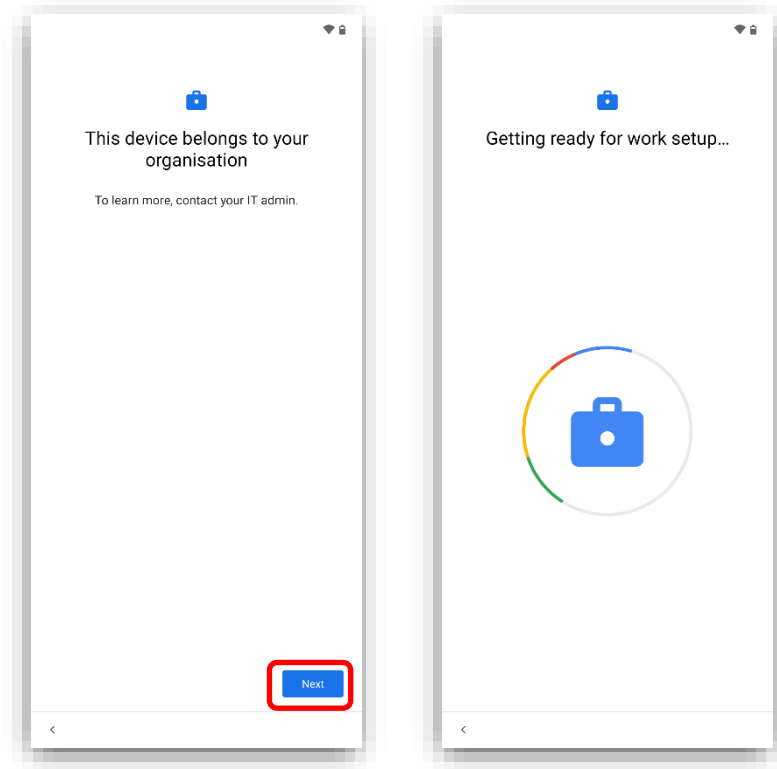

- Confirm the following queries with "Next".

2.2 Log in with the DB User

Now enter your DB user login data.

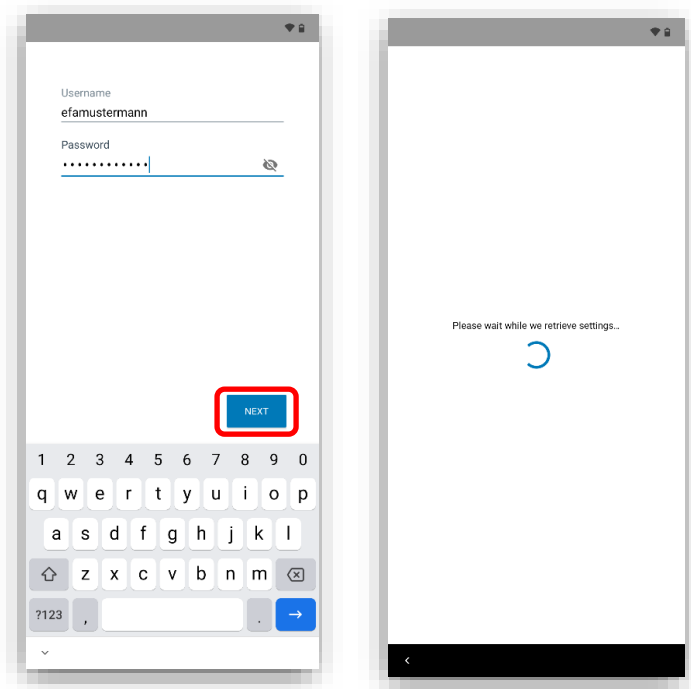

- **DB User Login Name:** Enter the *user name* (without spaces, no DB e-mail).
- **DB User Password:** Type in the *password*. If you don't remember your password, you can change it > [here](#).
- Then tap on "Next".

The link with the **DB network** (more precisely the Enterprise Mobility Management, EMM for short) starts.

2.3 Work profile

The applications (apps) will now be installed automatically. This process can take a few minutes. The work profile is then set up.

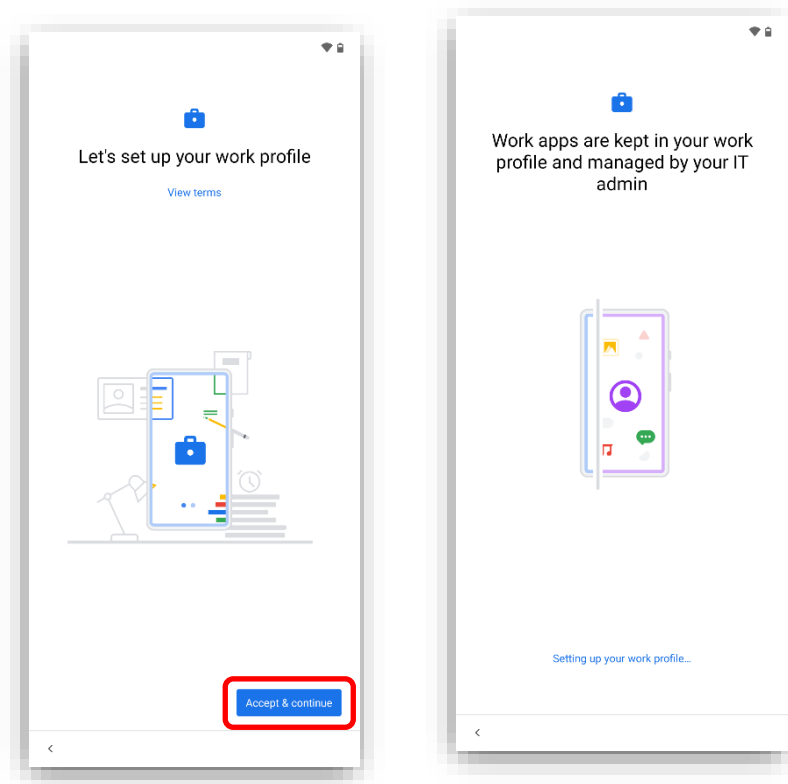

- Tap "Accept & continue" to set up the work profile.
- Then tap on "Next".

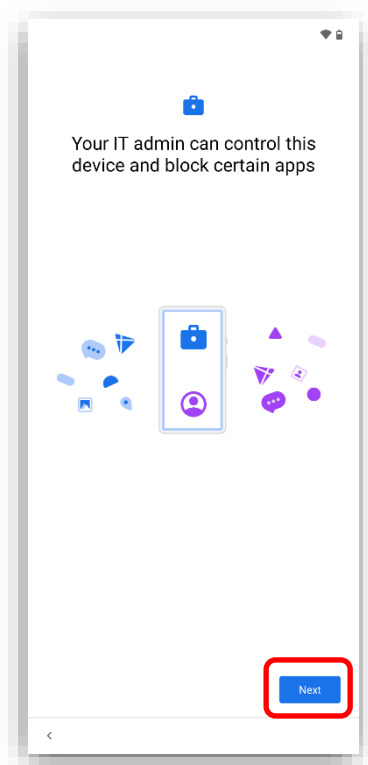

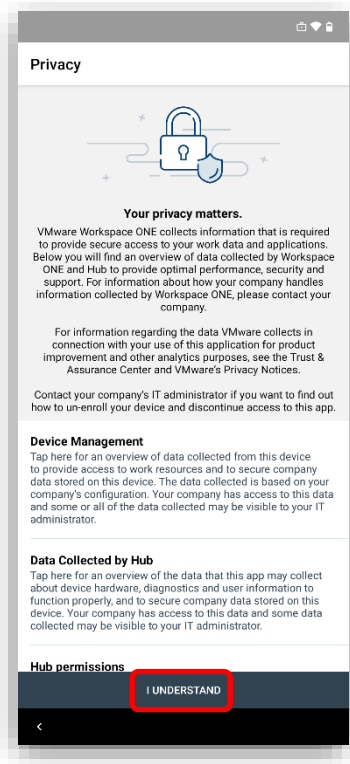

■ On the next page, agree to the privacy policy by tapping "*I understand*".

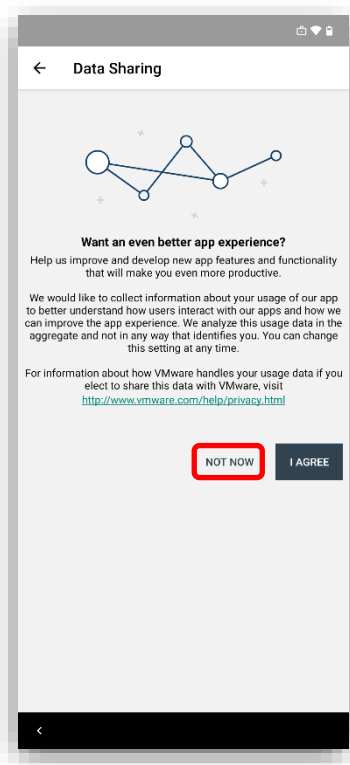

■ Select "*Not now*" on the next page.

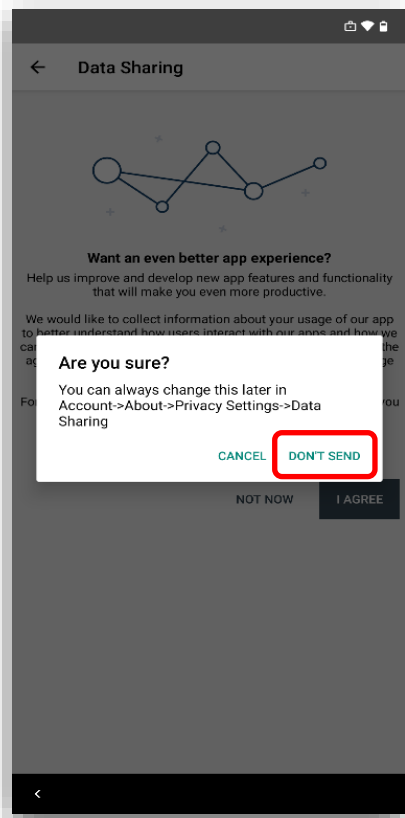

- Then tap on "*Do not send*" so that no usage data is sent.

2.4 Only for Android version 12: Create screen lock (password)

Android version 11: Jump to point 2.6

Next, set up a screen lock password for the smartphone/tablet. This is a data protection requirement for DB:

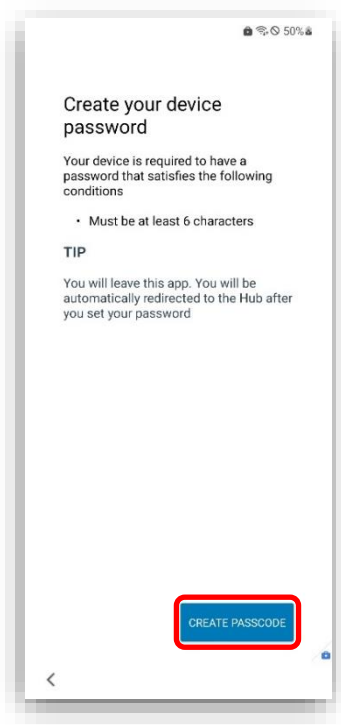

- Tap on "Create passcode".



- Select between the three options on the next page. The combination with a fingerprint is optional and not possible with all Android versions. If you do not want to scan a fingerprint, tap "*Continue without fingerprint*".

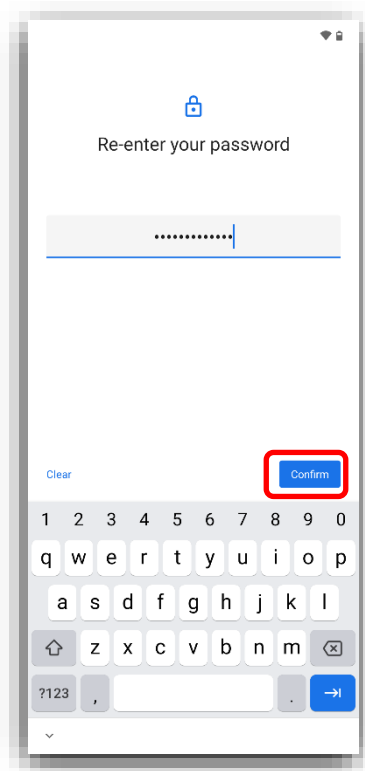
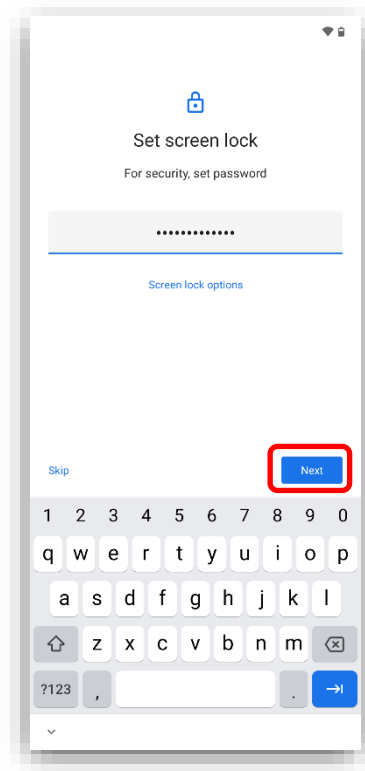

- Think of a character string that has at least 6 characters. Enter it twice in succession and tap "Next".
- **Note:** A PIN must be at least 6 digits long and must not be an ascending or descending sequence of digits.

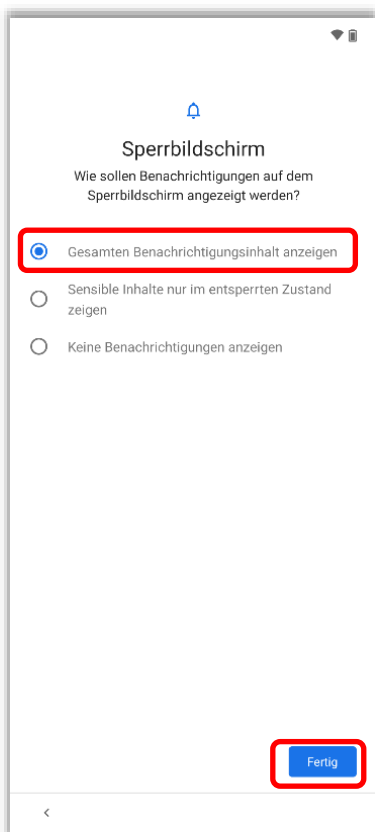

- **For lock screen:** Select "Show sensitive content only when unlocked" and then tap "Done". This way, no sensitive information is visible when the screen is locked.

2.5 Skip Google Services

You will now be asked for a private Google account. This is not required for the installation and use of DB Apps, so skip the setup. If you want to set up your private account, you can do so later if necessary.

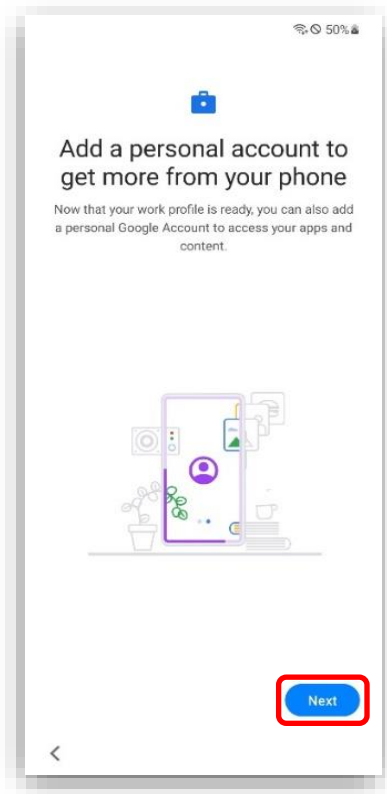

- Therefore tap on "Next"
- Tippe bei „Apps & Daten kopieren“ auf „Nicht kopieren“.

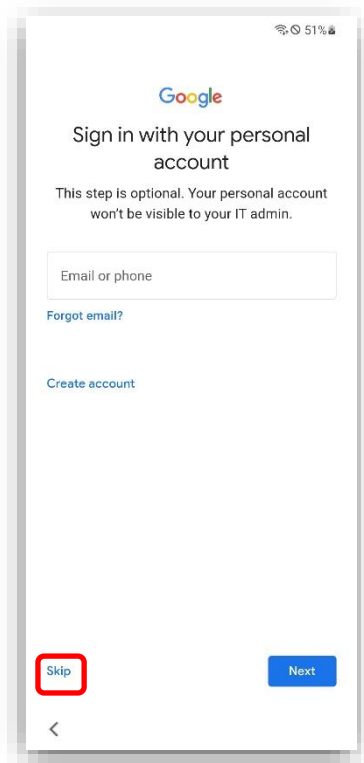

- Then tap on "Skip".

To use the Google Play Store for business apps, it is necessary to accept the Google Terms of Use. Proceed as follows:

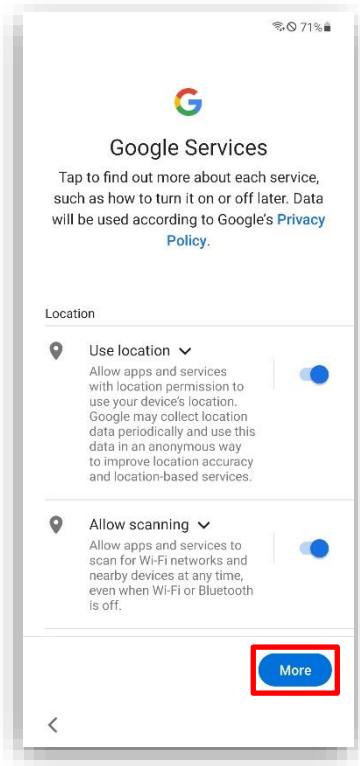

- **Send usage data & error reports:** Slide the slider to the left to switch off the function.
- Tap on "More".

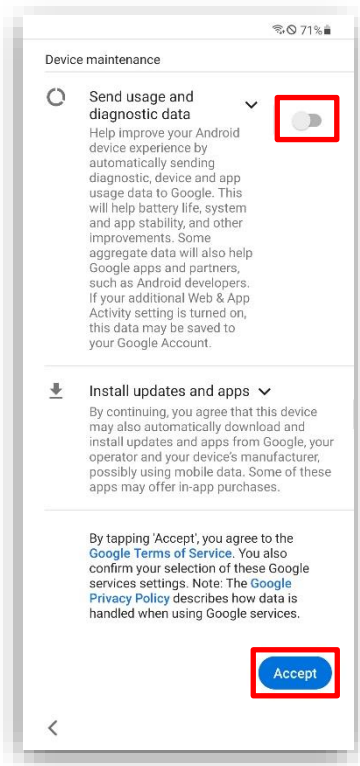

- Scroll all the way down and then tap "Accept".

2.6 Only for Android version 11: Create screen lock (password)

Next, set up a screen lock password for the smartphone/tablet. This is a data protection requirement for DB:

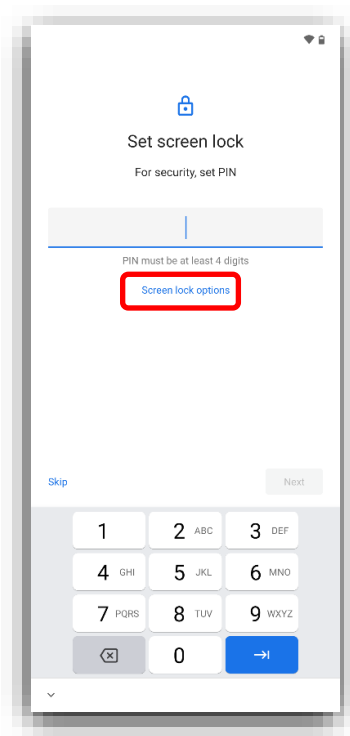

- Tap on "Screen lock options".

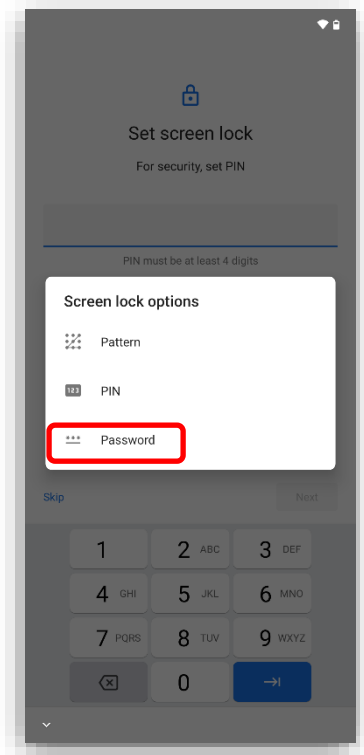

- Select "Password" on the next page.

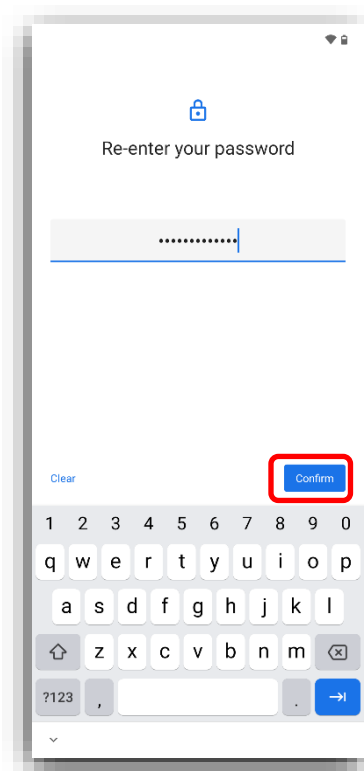
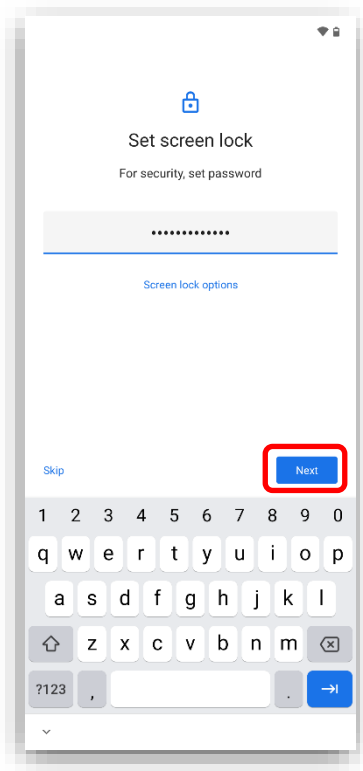

- Think of a character string that has at least 6 characters (at least one of which is a letter). Enter it twice in succession. Tap on "Confirm".

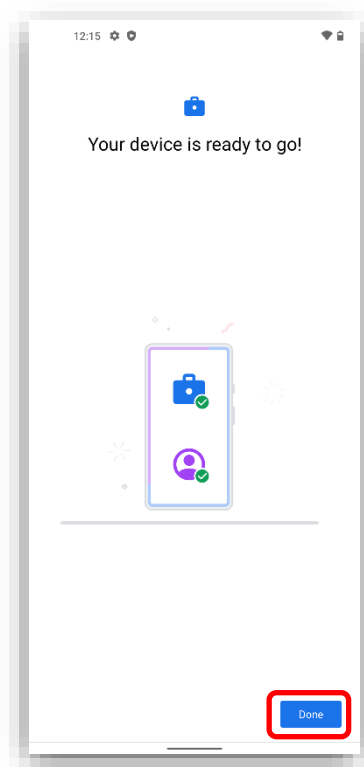

- Tap on "Done".

2.7 Finalise setup

Swipe the screen once from top to bottom. The control centre opens and the notification area below it.

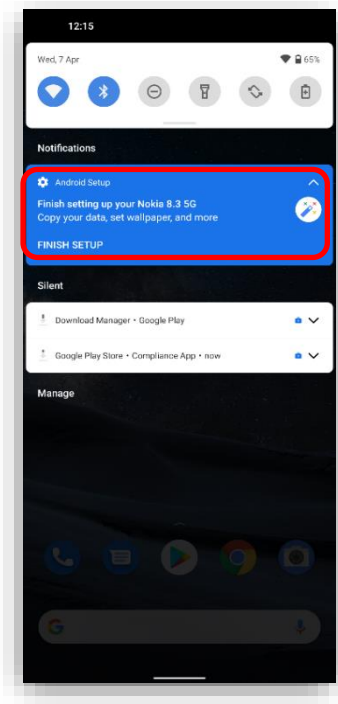

- Tap on "*Complete setup*" (depending on the device, the device type is listed here).

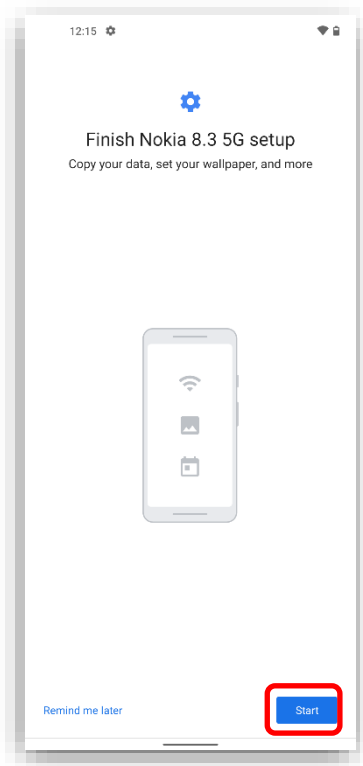

- Then tap on "*Start*".
-

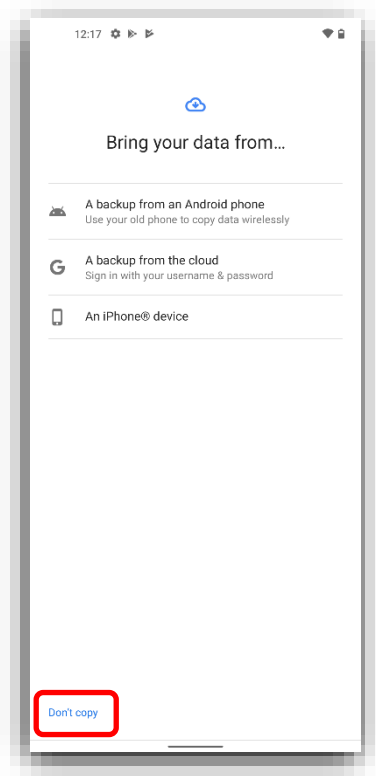

- On the Import Data page, tap "Don't copy".

Android 11:

You can then set up the unlocking of your smartphone/tablet with fingerprint or face recognition.

- Tap "Skip" several times.

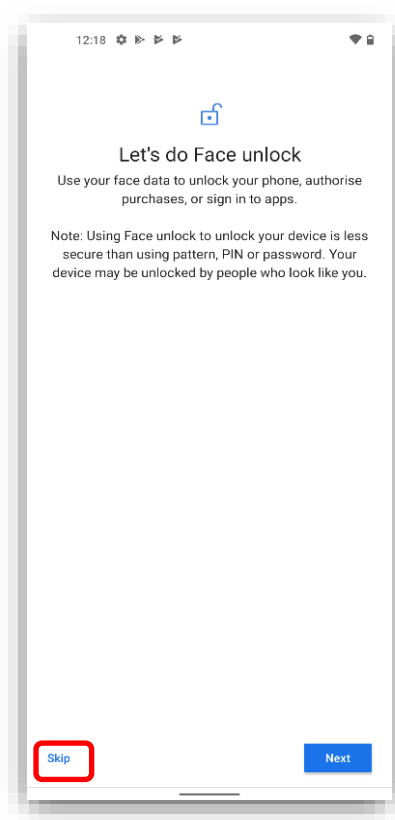
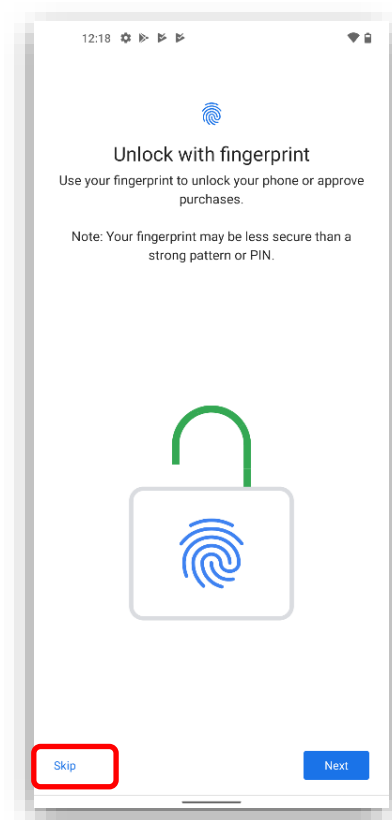

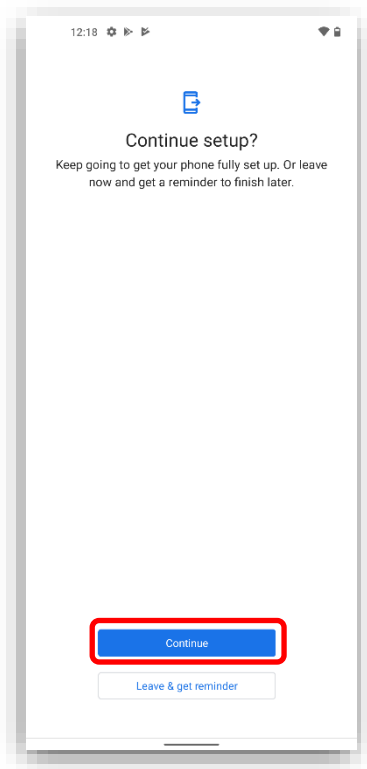

■ In the next step, tap on "Next".

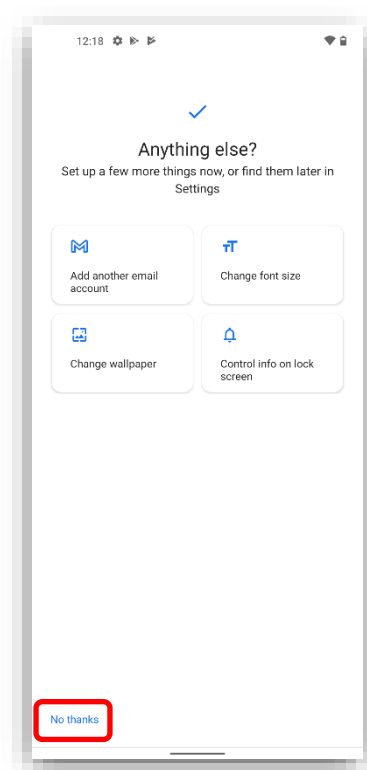

■ If you do not want to make any further adjustments, tap "No thanks" afterwards.

2.8 Check certificates

Swipe the screen once from top to bottom. The control centre opens and the notification area below it.

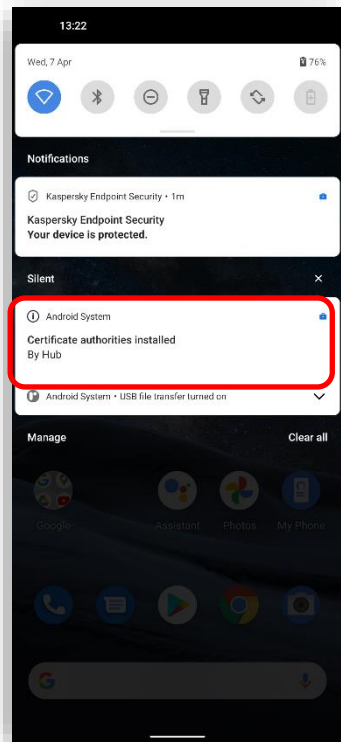

■ Tap on "Certification authority installed".

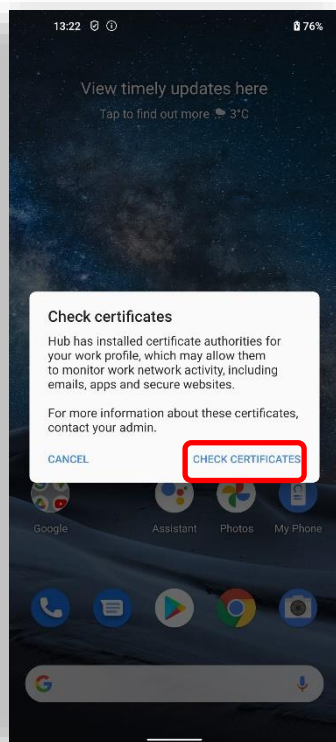

■ Then tap on "Check certificates".

■

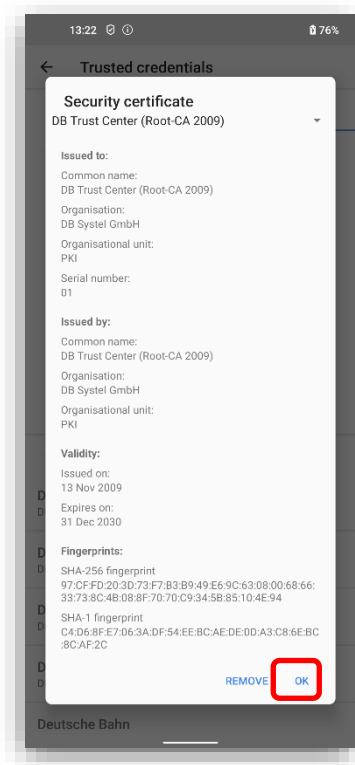

- Confirm the certificates with "OK".
- When asked for a password, enter the screen lock password. This is the password you set earlier.

Then swipe the screen from bottom to top. This will take you to your smartphone/tablet home screen.

3 Necessary settings

3.1 Search for operating system updates

Go to the "*Personal*" / "*Private*" section on your smartphone/tablet.

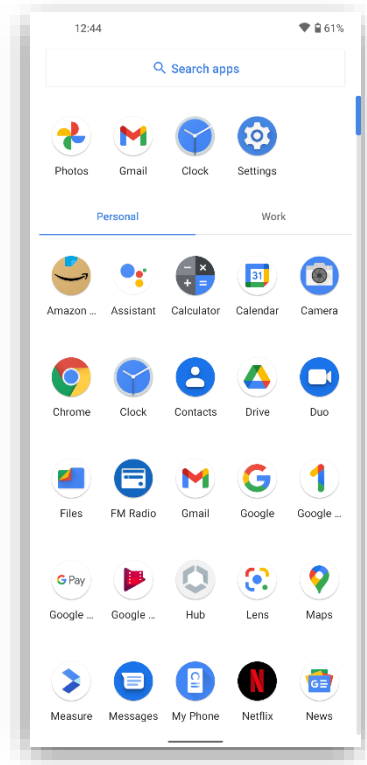

■ Tap on the "*Settings*" app.

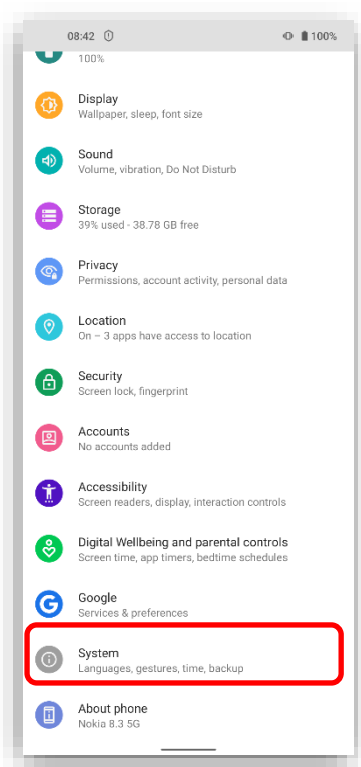

■ Scroll down and select "*System*".

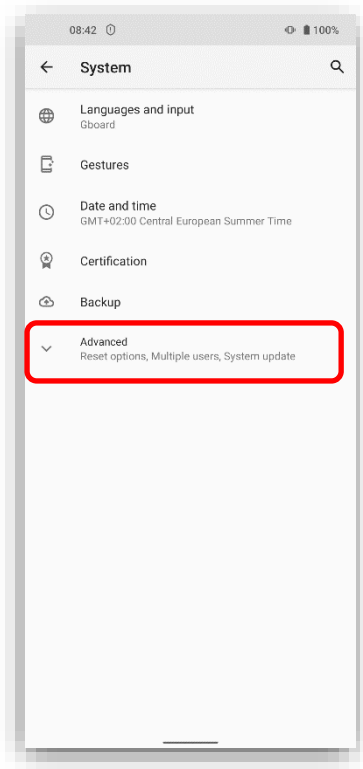

■ Tap on "Advanced".

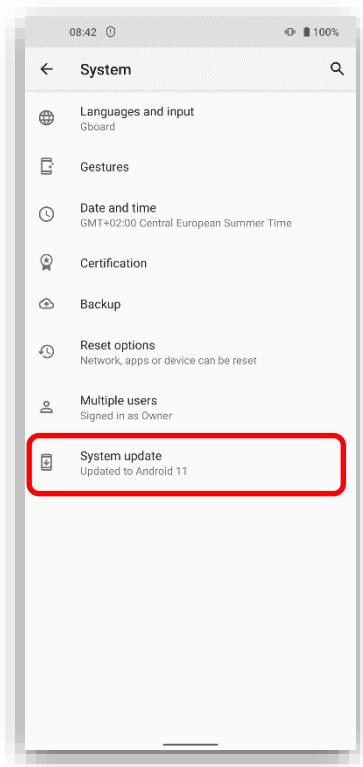

■ Tap on "System update".

There you will see whether an update is available. Carry out pending updates by tapping on "Install update".

3.2 Activate Welcome App

Now activate the Welcome App so that you can use all DB apps.

- Start the Welcome App in the "Work"/"Business" area.
- Confirm the following messages with "Next".
- Tap on "Start activation".

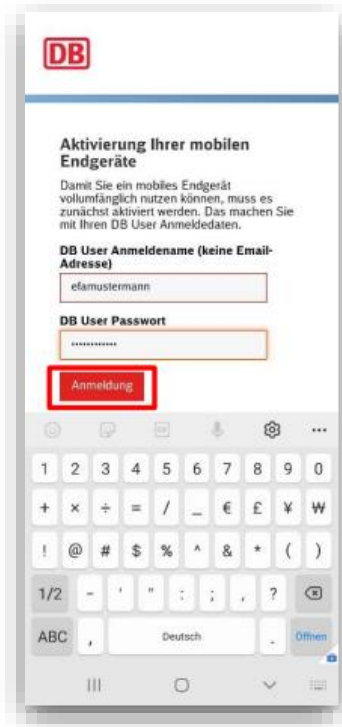

- Enter your DB user login name and DB user password in the fields.
- Tap on "Log in".

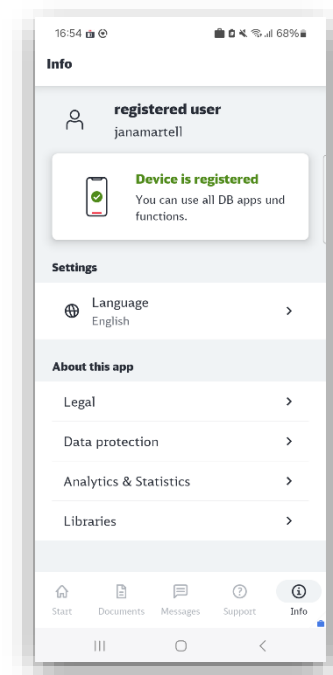

- Wait approx. 30 minutes. (Please note: sometimes it takes a little longer or a very long time to activate your device. Please be patient here).
- You will see the message "Device is activated" on the Info tab in the Welcome App and when DB Apps are visible on your device.

If you receive an error message, activate the device again:

- To do this, go to the Help tab and tap on "Activate again".
- Only then can you download and work with all other necessary DB apps

3.3 Activate MTD App

The Mobile Threat Defence (MTD) app is automatically installed on your smartphone/tablet after recovery. To enable it to detect security vulnerabilities on your device, proceed as follows:

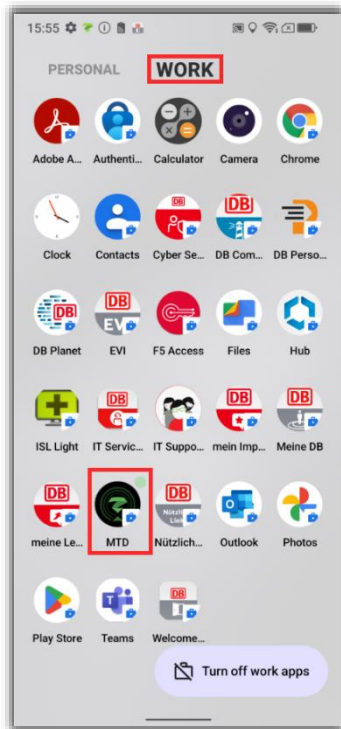

- Tap the app icon in the "Work"/"Business" area.

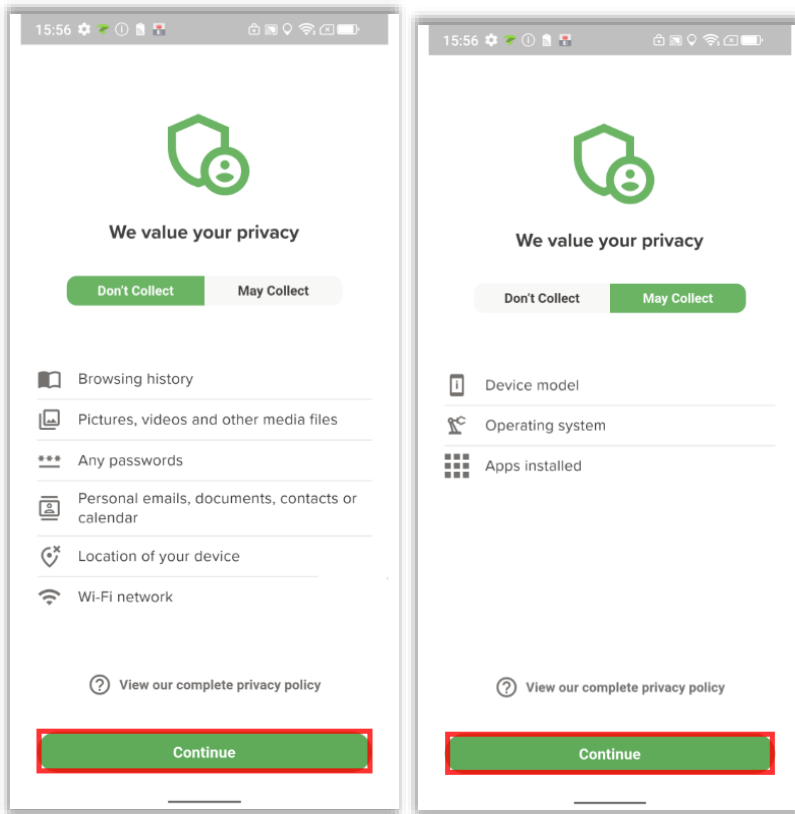

You will now see the "Privacy" settings. This screen is for information only. No action is required by you.

- **Don't Collect:** Here you can see which data the MTD app is not allowed to collect.
- **May Collect:** Here you can see what data the MTD app is allowed to collect.
- Tap "Continue".

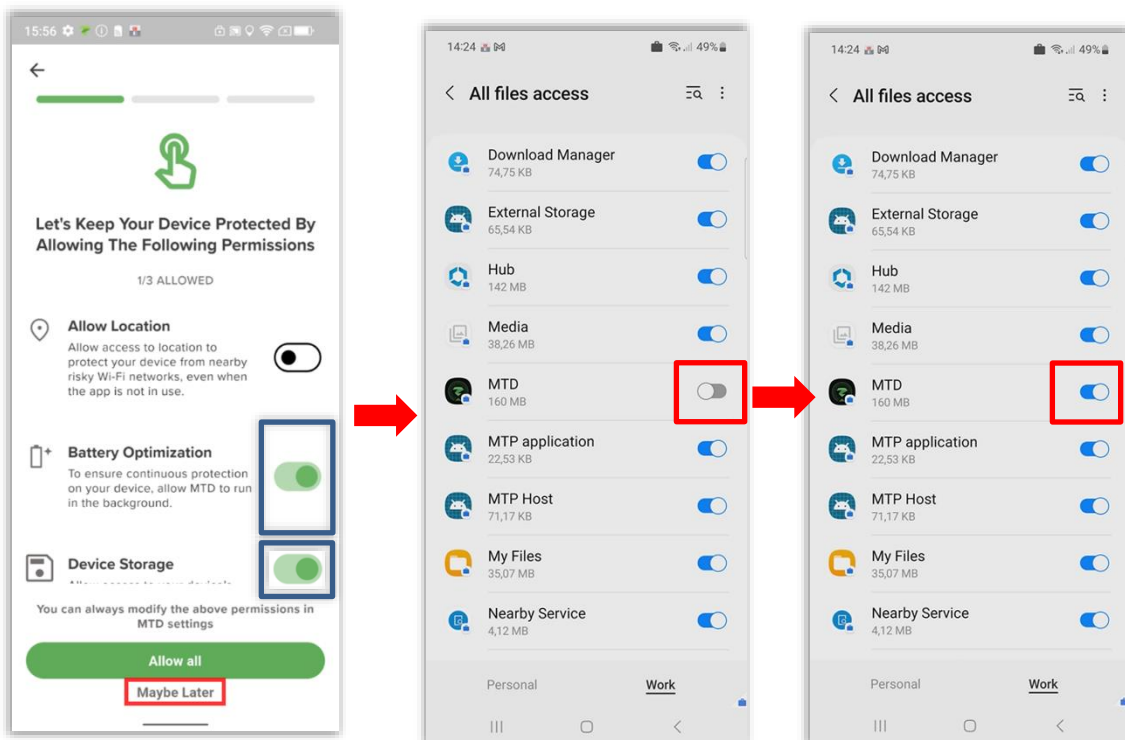

In the next step, you will be asked to set up some permissions for the MTD app.

- **Allow Location:** Leave slider to left (not activated).
- **Battery Optimisation:** Move slider to right (activated).
 - This option is **mandatory** for the MTD app to provide continuous protection in the background. The tested Battery consumption is minimal.
- **Device Storage:** Move slider to right (activated).
 - This option is **mandatory** for the MTD app for the detection of Malware which could spread on your device. This is the only way to provide a thorough protection.
- Then tap “Maybe Later”.

You will now see the following screen:

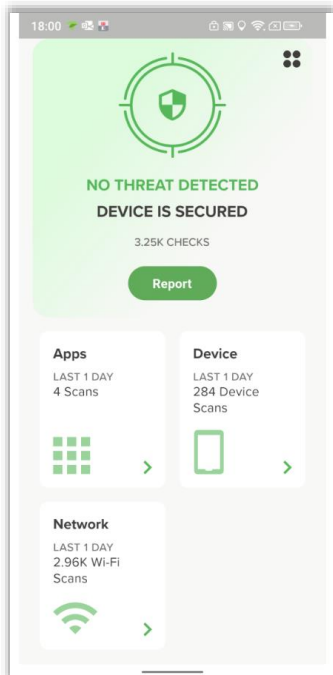

The activation is now complete. The MTD app will now detect threats on your smartphone/tablet.

- Detailed step-by-step instructions: > [Setup MTD.](#)
- More information about MTD on the DB Planet page of > [Endpoint Security.](#)

Congratulations - you have successfully restored your work smartphone/tablet!

You can find more information about your smartphone/tablet under Set up in the Welcome app.